

BETTER HOME PRODUCTS

CURVED SHOWER ROD SPECIFICATIONS

BHP Crescent Rod[®]

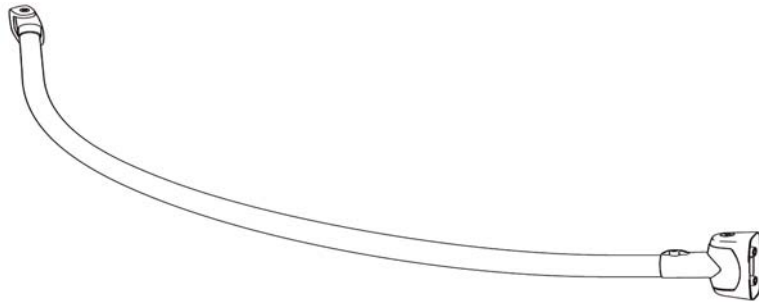

ITEM# 100CH, 100SN, 100DB

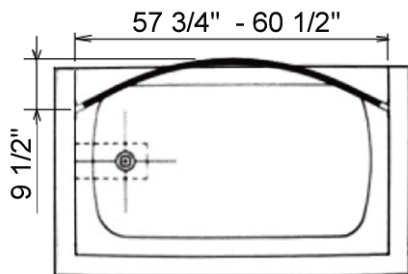

Application: 5' standard or oval bath tub
Length: 57.75" - 60.50" without modification
Rod Material: Type 304 stainless steel
Rod OD: 1"
Rod Wall Thickness: 0.75mm
Curtain: Standard shower curtains will fit (Not included)
Available Finishes: Chrome, Satin Nickel and Dark Bronze

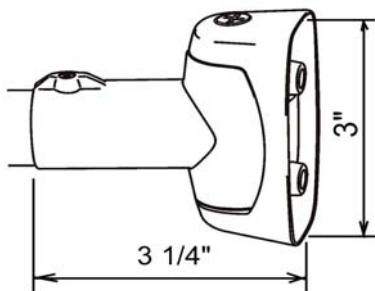

Brackets (set):
Die cast zinc, wall mount, with swivel connectors
2 Pcs retaining screws
Mounting Hardware:
4 Pcs decorator anchors
4 Pcs plug anchors
4 Pcs wood screws
2 Pcs SS headless set screw